

SCHEDA TECNICA ON-OFF

STAGE PLAN

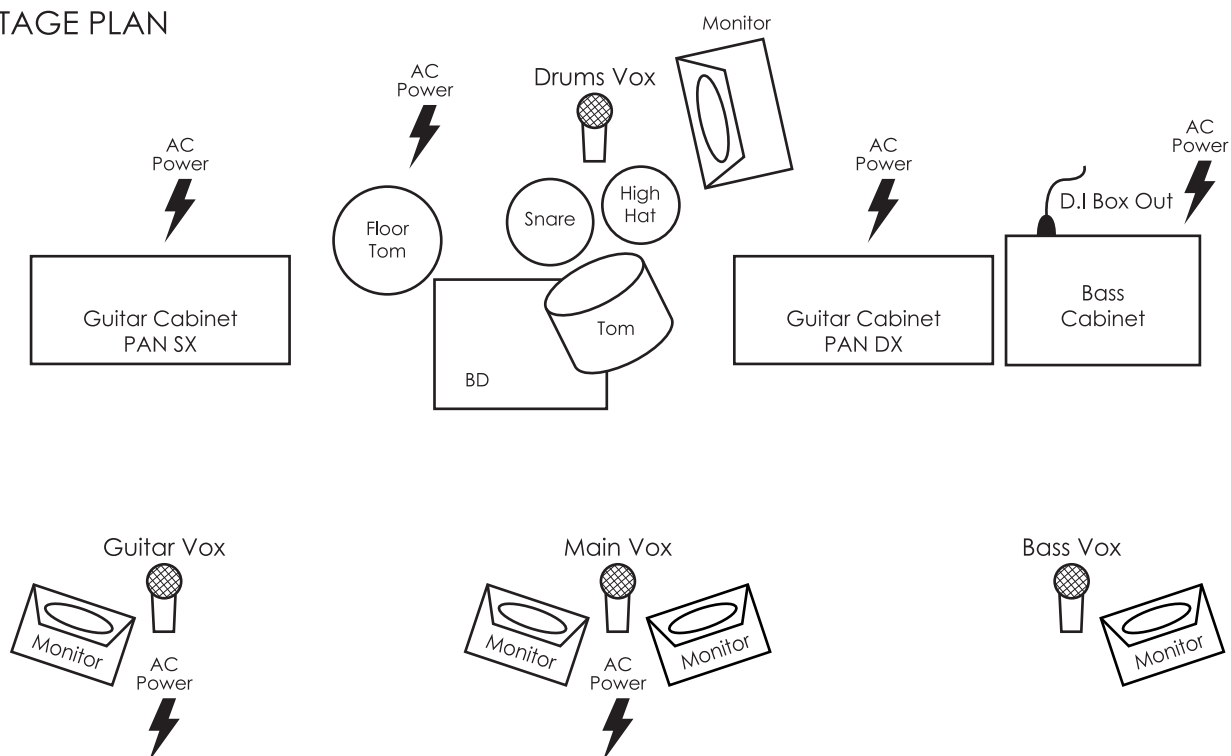

IMPULS LIST:

Channels	Mics	OutBoard
1 BD	D112	Comp.
2 SD up	SM57	Comp.
3 SD down	S.D.C./SM57	-
4 HH	S.D.C.	-
5 Tom	MD421/SM57	-
6 Fl. Tom1	MD421/SM57	-
7 OH Left	C414/S.D.C.	-
8 OH Right	C414/S.D.C.	-
9 El. Bass D.I.	D.I. Box	Comp./Limiter
10 El. Bass	MD421	-
11 El. Guitar1	E606	-
12 El. Guitar1	SM57 (for solo)	-
13 El. Guitar2	E606	-
14 El. Guitar2	SM57 (for solo)	-
15 Back Voice Left Guitar	SM58	-
16 Back Voice Drums	SM58	-
17 Back Voice Right Bass	SM58	-
18 Lead Voice	SM58 (No BETA58!!)	Comp./Limiter
19 FX Return Left	-	Rev.
20 FX Return Right	-	Rev.
21 CD Left	-	CD Player
22 CD Right	-	CD Player

- Mixer: minimo 24 ch. mono (insert point su ogni canale) + 2 stereo ch.; 6 aux send; 4 sub groups.
- P.A.: adeguato alla location
- Monitor: minimo 4 monitor (2 linked per il cantante) >vedi stage plan per il posizionamento.
- Outboards: almeno un riverbero di buona qualità (TC Electronic; Lexicon; Eventide;...).
- Mic: Noi disponiamo di 1x SM57, 1x SM58, 2x E606 + eventuali altri mic voce.